

Ceiling

Gypsum Boards

The Application of Drywall System

Main Advantages

1. Fire Proof:

Fire Proof Gypsum Board was tested by the National Center for Quality Supervision. It is designed for fire insulation up to 1-3 hours.

2. Moisture / Water Proof

Moisture / Water Proof Board is excellent in Moisture / Water resistance. It is made from extra tough paper mixed with wax, and the compound of gypsum board has silicone which reduces moisture absorption of the board.

3. Heat Insulation

Gypsum Board has heat prevention material incorporated, it has great feature of heat prevention. Thermal resistance is 1.14m²k/w

4. Sound Insulation

Gypsum Board proved to have good noise insulation property after inspected by the National Center for Quality Supervision and Testing of Fire Building Material (NFTC), The noise insulation factor of the wall can reach 44dB and 47dB. It has the best noise insulation constitution in China, especially the 95mm wall comprised by the 10mm board.

5. Commercial Building Material

Gypsum Board is ideal for ceiling and single layer partition in residential and commercial building. It can save time, space, and expense. It is a new and high efficient wall.

Specifi Cation

Wall: Width x Length 2400 x 1200(mm)

Thickness: 6-12(mm)

Ceiling: Width x Length 2400 x 1200 or 600 x 600(mm)

Thickness: 5-6(mm)



Gypsum Boards

The Application of Drywall System

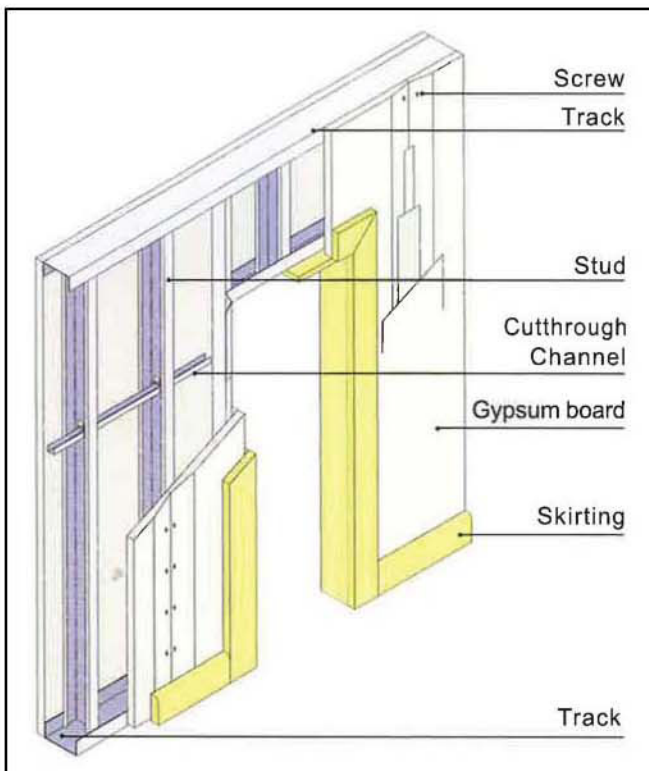
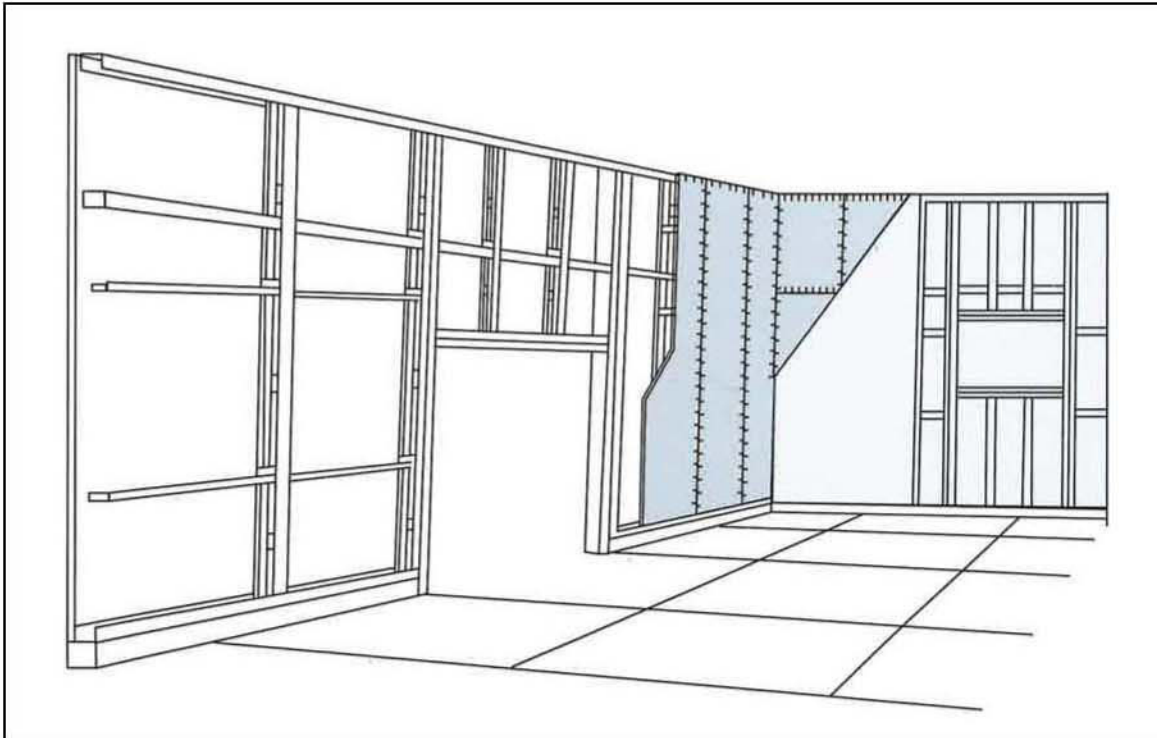

1. Draw the installation guideline.
2. Use the shooting nail or expansion bolt to fix keel on the ceiling and floor.
3. And arrange the vertical keel as per the request and install the horizontal keel.

■ Fixing method of the board

1. To cut the board as per the required size.
2. The boards should be fixed on the keels by the tapping screws in seam misplacement form, the distance between tapping screws is 250mm. And each screw head should enter 0.5m depth into the board.
3. Please leave a seam between boards about 2 mm width.
4. When fixing the board, it should be mounted from its center to the edges. Don't fix it at different points at the same time avoid the over bending of the board.

Ceiling

Gypsum Boards

Gypsum Board Description

Gypsum Board is used natural gypsum powder through special treatment then together with high quality face paper as made.

Function:

1. Interior wall and partition
2. For ceiling system
3. Sound-adsorbing wall body
4. Fire-proof
5. Damp-proof
6. Durability and long service life
7. High strength
8. Good heat and sound insulation

Specifications: 1220mm × 2440mm; 1200mm × 2400mm; 3000mm × 1200mm; 2500mm × 1200mm;
Thickness: 7mm-15mm. Other optional specifications available

Standard Specification: Products meet national standards of China, ISO gypsum board standard and the CE standards.

Beside, we also do the customers-made according to your special requirements.

ITEM	EDGE	LENGTH	WIDTH	THICKNESS
PLASTERBOARD	TAPERED SQUARE	2400	1200	9.5
		2440	1200	12.0
		2700		12.5
		3000		12.7
		3600		15.0
		3660		15.9

THICKNESS	LOAD BREAKING STRENGTH		REMARKS COLUMN:NON-NATIONAL STANDARD PRODUCTS,AND RELEVANT DATA CAN BE FOUND THOUGH ASTM C13960-04,BS1230 AND ISO6308 STANDARDS DOCUMENTS.
	VERTICAL	HORIZONTAL	
9.5	360	140	
12.0	500	180	
15.0	650	220	



Gypsum Boards

Calcium Silicate Board System

Installation of Partition System

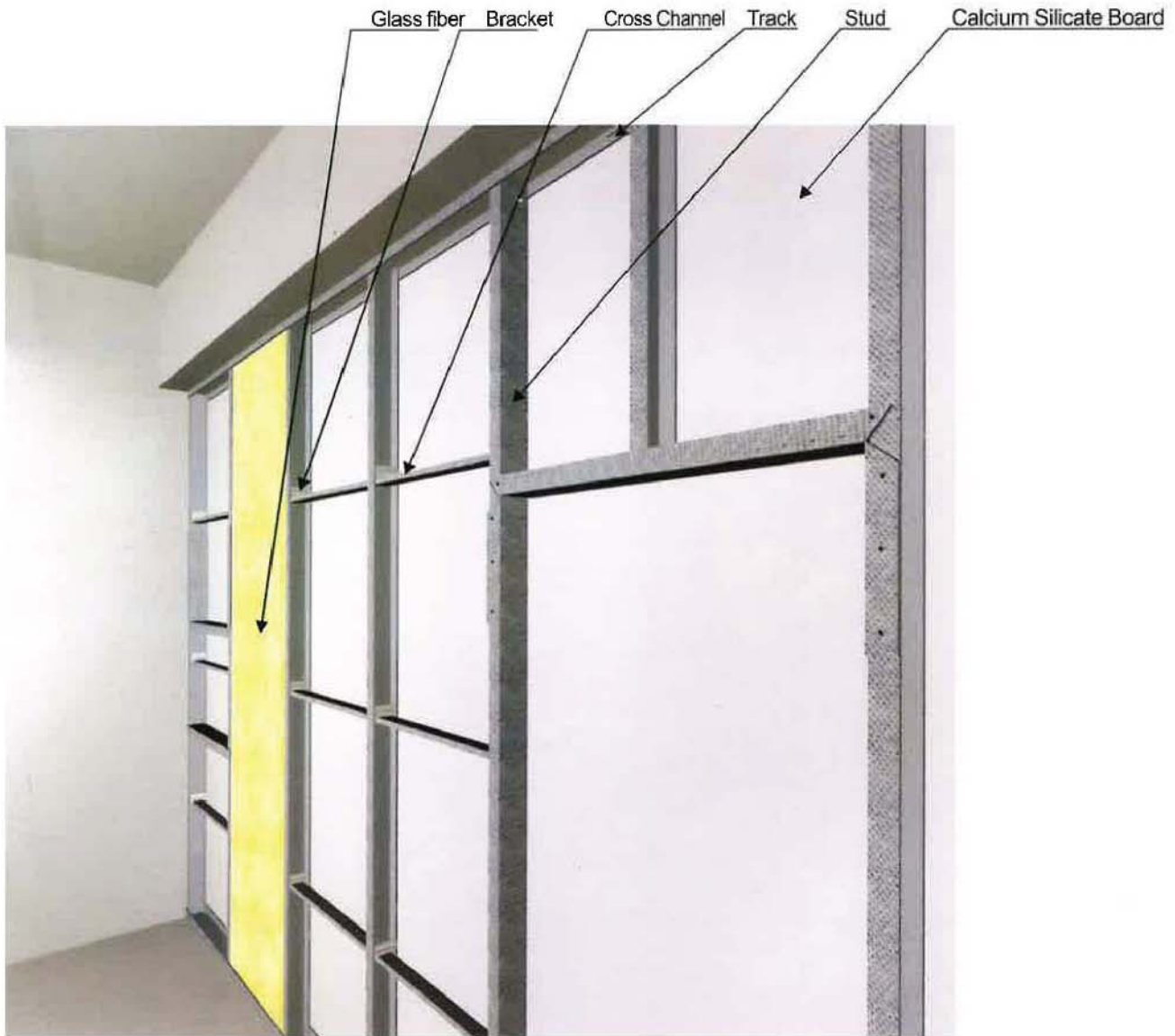

Ceiling



Ceiling

Gypsum Boards

Calcium Silicate Board System

Installation of Ceiling System



Advantages:

Calcium silicate board is a new green building material. With silicate and calcium materials as base and wood fiber as strengthen, which has the advantage of high strength, anti freeze, water-resist, fire-proof, damp-proof, sound-absorption, no distortion and no radiation...etc.

Features

Length: 2440mm or 595mm or 600mm or 603mm

Width: 1220mm or 595mm or 600mm or 603mm

Thickness: 4-30mm or 4-6mm

Materials: Tobermorite, Cao, Quartz sand, reinforced wood fiber

Application:

Interior and Exterior wall partition, suspended ceiling, fireproof board.

Also can be used for: Commercial and industrial construction, residential building, movie theaters, exhibition halls, restaurants, hotels, hospitals, tran station or MRT stations and so on.